



Centrifugal Sanitary Pumps

CR series

Standard design

Centrifugal pumps incorporating a special auger type screw shaped impeller, which is ideal for the gentle handling of very delicate fluids and large soft solids in suspension.

Wetted parts in investment cast CF-3M 1.4404 / AISI 316L stainless steel, electro-chemically polished to ensure the perfect surface finish.

Separate IEC standard motor:
Stainless steel shroud and adjustable feet on request.

Flow rates range from 0 to 150 m³ /h, heads up to 20 m (2 bar).

The clamp casing and seal design allows quick disassembly for inspection, cleaning and maintenance. It also enables the delivery port to be rotated to any position for easy installation.

Seals:

Mechanical seals seats to EN 12756, ISO 3069 standards.
Single internal mechanical seal
Single external mechanical seal
Double flushed mechanical seal

Elastomers (certified to FDA):

EPDM
Fluorocarbon (Viton)
Silicone
P.T.F.E. (FEP)

Connections:

DIN - SMS - IDF - BS / RJT - DS - CLAMP and EN 1092-1
PN16 flanges to suit most international standards.

Applications

Delicate handling without clogging.
The CR Series has been designed for very gentle handling of sensitive media at extremely low flow velocities. The screw shape impeller combines the properties of a centrifugal pump with the delicate characteristics of a positive displacement pump. The ability to handle high solids products in an extremely gentle way makes CR Series pumps ideal for food processing.

- Fruit and vegetable handling
- Soups and sauces
- Cereals
- Fish transportation
- Food pastes
- Oil
- Wine recirculation

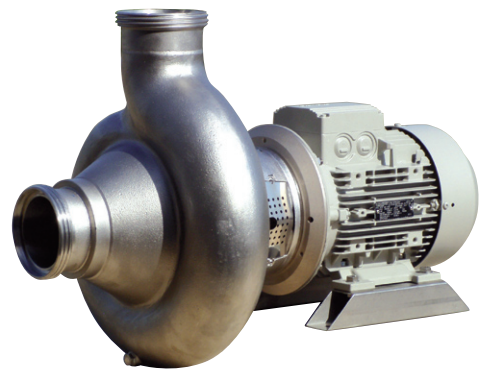

CR pump



CR pump with shroud

GENERAL DIAGRAMS

POMPA TIPO <i>Pump type</i>		CR 65			n 920/1110	giri / min <i>r. p. m.</i>
GIRANTE — Impeller						
TIPO <i>Type</i>	N° di pale <i>n° of vanes</i>	Pass. sferico <i>max. sphere</i>	Ø max <i>max. diameter</i>	Ø min <i>min. diameter</i>	Bocche tipo <i>Ports type</i>	Bocca aspir. <i>Suction port</i>
APERTA	1 Elica	33 mm	156 mm	— mm	DIN 11851	DN 65
					Bocca mand. <i>Discharge port</i>	DN 65
CARATTERISTICHE DI FUNZIONAMENTO CON ACQUA PULITA A 20°C - PESO SPECIFICO 1 (kg/dm ³) <i>Curves show performance with clear water at 70°F - Specific gravity 1 (kg/dm³)</i>						

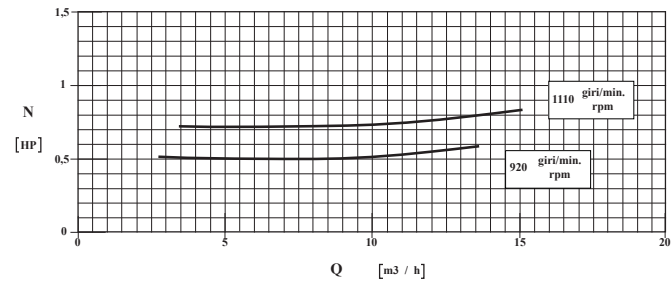
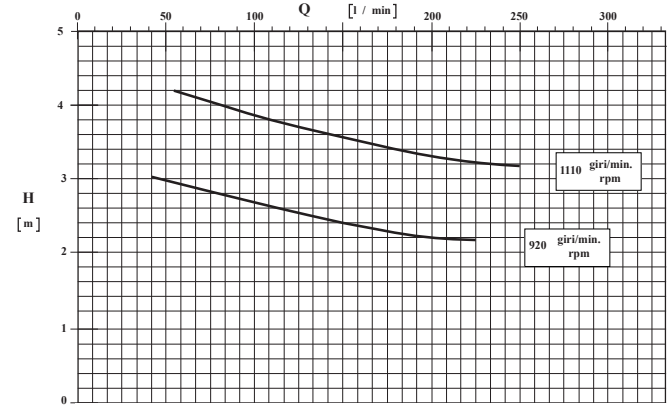

POMPA TIPO <i>Pump type</i>		CR 80			n 960/1150	giri / min <i>r. p. m.</i>
GIRANTE — Impeller						
TIPO <i>Type</i>	N° di pale <i>n° of vanes</i>	Pass. sferico <i>max. sphere</i>	Ø max <i>max. diameter</i>	Ø min <i>min. diameter</i>	Bocche tipo <i>Ports type</i>	Bocca aspir. <i>Suction port</i>
APERTA	1 Elica	45 mm	178 mm	— mm	DIN 11851	DN 80
					Bocca mand. <i>Discharge port</i>	DN 80
CARATTERISTICHE DI FUNZIONAMENTO CON ACQUA PULITA A 20°C - PESO SPECIFICO 1 (kg/dm ³) <i>Curves show performance with clear water at 70°F - Specific gravity 1 (kg/dm³)</i>						

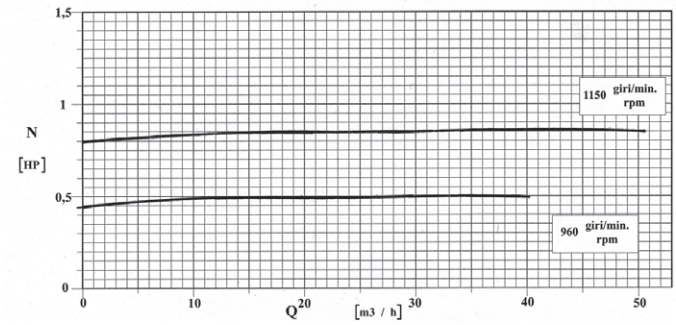
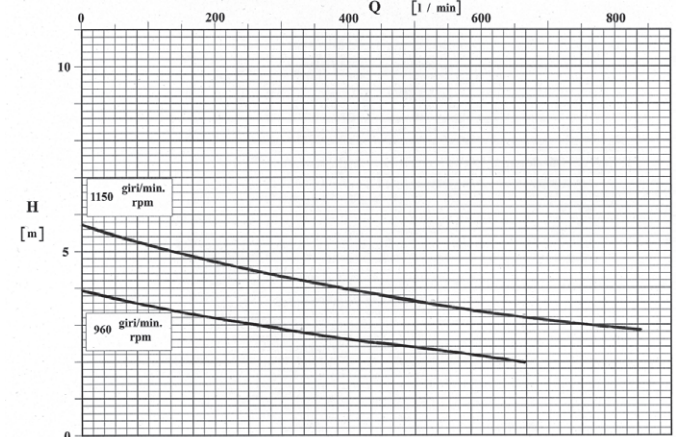

POMPA TIPO <i>Pump type</i>		CR 100			n 960/1150	giri / min <i>r. p. m.</i>
GIRANTE — Impeller						
TIPO <i>Type</i>	N° di pale <i>n° of vanes</i>	Pass. sferico <i>max. sphere</i>	Ø max <i>max. diameter</i>	Ø min <i>min. diameter</i>	Bocche tipo <i>Ports type</i>	Bocca aspir. <i>Suction port</i>
APERTA	1 Elica	58 mm	210 mm	— mm	DIN 11851	DN 100
					Bocca mand. <i>Discharge port</i>	DN 100
CARATTERISTICHE DI FUNZIONAMENTO CON ACQUA PULITA A 20°C - PESO SPECIFICO 1 (kg/dm ³) <i>Curves show performance with clear water at 70°F - Specific gravity 1 (kg/dm³)</i>						

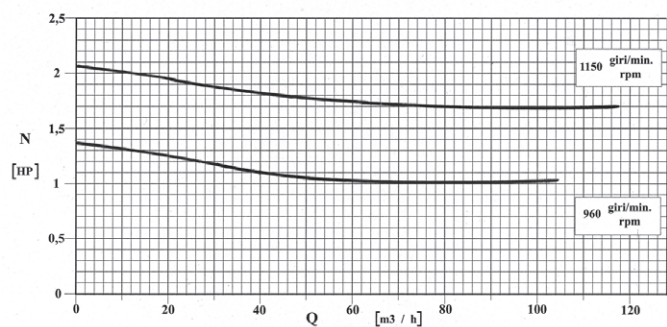
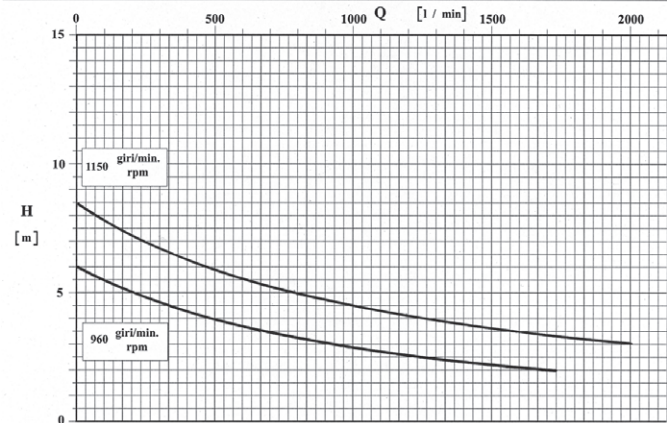

POMPA TIPO <i>Pump type</i>		CR 125			n 960/1150	giri / min <i>r. p. m.</i>
GIRANTE — Impeller						
TIPO <i>Type</i>	N° di pale <i>n° of vanes</i>	Pass. sferico <i>max. sphere</i>	Ø max <i>max. diameter</i>	Ø min <i>min. diameter</i>	Bocche tipo <i>Ports type</i>	Bocca aspir. <i>Suction port</i>
APERTA	1 Elica	63 mm	260 mm	— mm	DIN 11851	DN 125
					Bocca mand. <i>Discharge port</i>	DN 125
CARATTERISTICHE DI FUNZIONAMENTO CON ACQUA PULITA A 20°C - PESO SPECIFICO 1 (kg/dm ³) <i>Curves show performance with clear water at 70°F - Specific gravity 1 (kg/dm³)</i>						

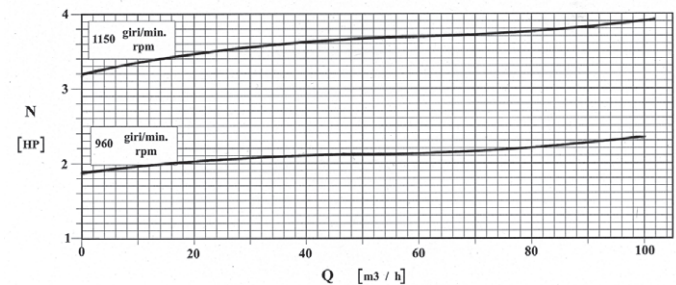
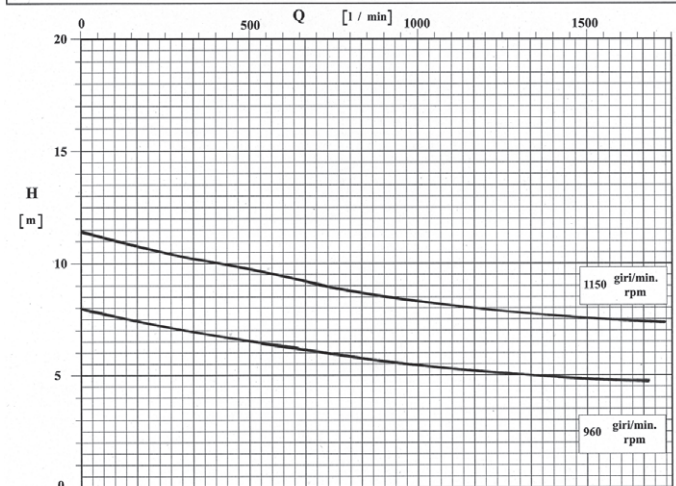

GENERAL DIAGRAMS

POMPA TIPO <i>Pump type</i>		CR 65			n 1400/1750 giri / min <i>r. p. m.</i>	
GIRANTE — <i>Impeller</i>						
TIPO <i>Type</i>	N° di pale <i>n° of vanes</i>	Pass. sferico <i>max. sphere</i>	Ø max <i>max. diameter</i>	Ø min <i>min. diameter</i>	Bocche tipo <i>Ports type</i>	Bocca aspir. <i>Suction port</i>
APERTA	1 Elica	33 mm	156 mm	---	DIN 11851	DN 65
						Bocca mand. <i>Discharge port</i>
						DN 65
CARATTERISTICHE DI FUNZIONAMENTO CON ACQUA PULITA A 20°C - PESO SPECIFICO 1 (kg/dm³) <i>Curves show performance with clear water at 70°F - Specific gravity 1 (kg/dm³)</i>						

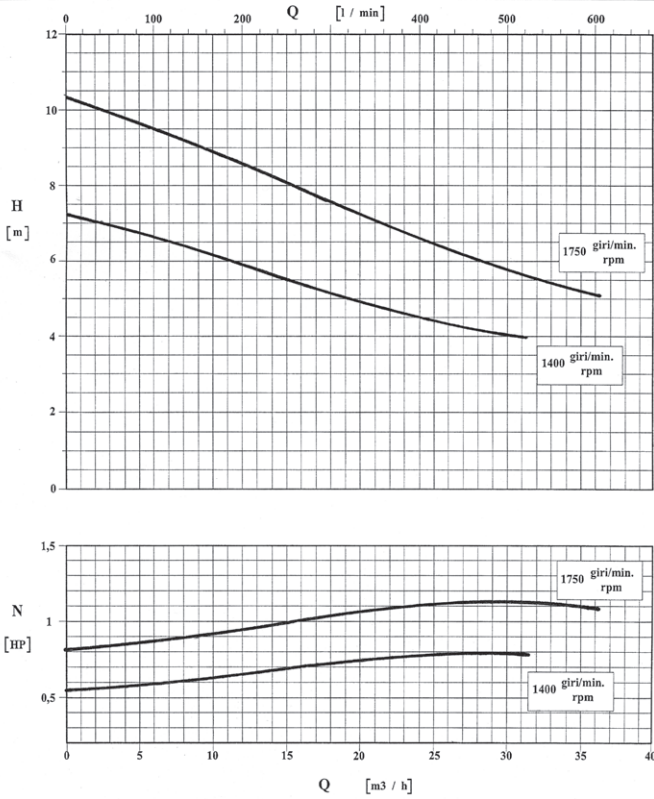

POMPA TIPO <i>Pump type</i>		CR 80			n 1450/1750 giri / min <i>r. p. m.</i>	
GIRANTE — <i>Impeller</i>						
TIPO <i>Type</i>	N° di pale <i>n° of vanes</i>	Pass. sferico <i>max. sphere</i>	Ø max <i>max. diameter</i>	Ø min <i>min. diameter</i>	Bocche tipo <i>Ports type</i>	Bocca aspir. <i>Suction port</i>
APERTA	1 Elica	45 mm	178 mm	---	DIN 11851	DN 80
						Bocca mand. <i>Discharge port</i>
						DN 80
CARATTERISTICHE DI FUNZIONAMENTO CON ACQUA PULITA A 20°C - PESO SPECIFICO 1 (kg/dm³) <i>Curves show performance with clear water at 70°F - Specific gravity 1 (kg/dm³)</i>						

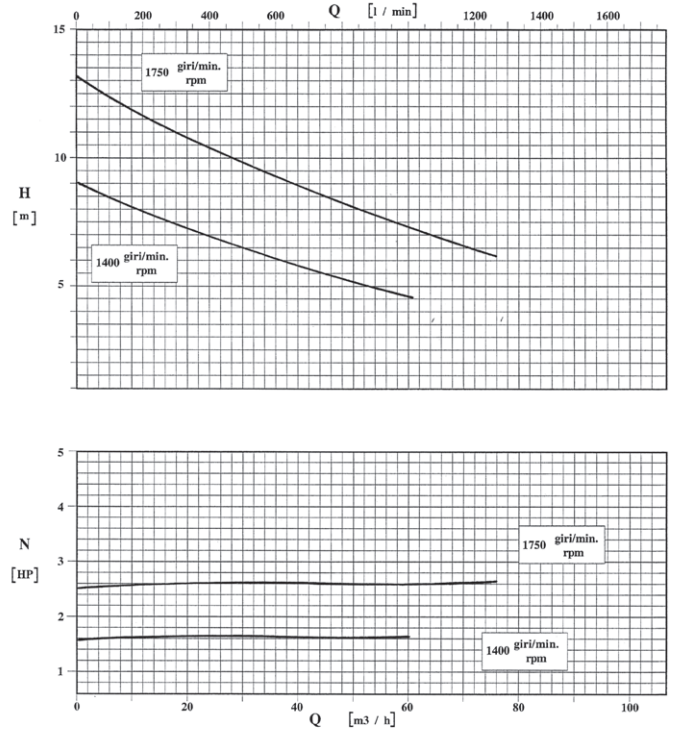

POMPA TIPO <i>Pump type</i>		CR 100			n 1450/1750 giri / min <i>r. p. m.</i>	
GIRANTE — <i>Impeller</i>						
TIPO <i>Type</i>	N° di pale <i>n° of vanes</i>	Pass. sferico <i>max. sphere</i>	Ø max <i>max. diameter</i>	Ø min <i>min. diameter</i>	Bocche tipo <i>Ports type</i>	Bocca aspir. <i>Suction port</i>
APERTA	1 Elica	58 mm	210 mm	---	DIN 11851	DN 100
						Bocca mand. <i>Discharge port</i>
						DN 100
CARATTERISTICHE DI FUNZIONAMENTO CON ACQUA PULITA A 20°C - PESO SPECIFICO 1 (kg/dm³) <i>Curves show performance with clear water at 70°F - Specific gravity 1 (kg/dm³)</i>						

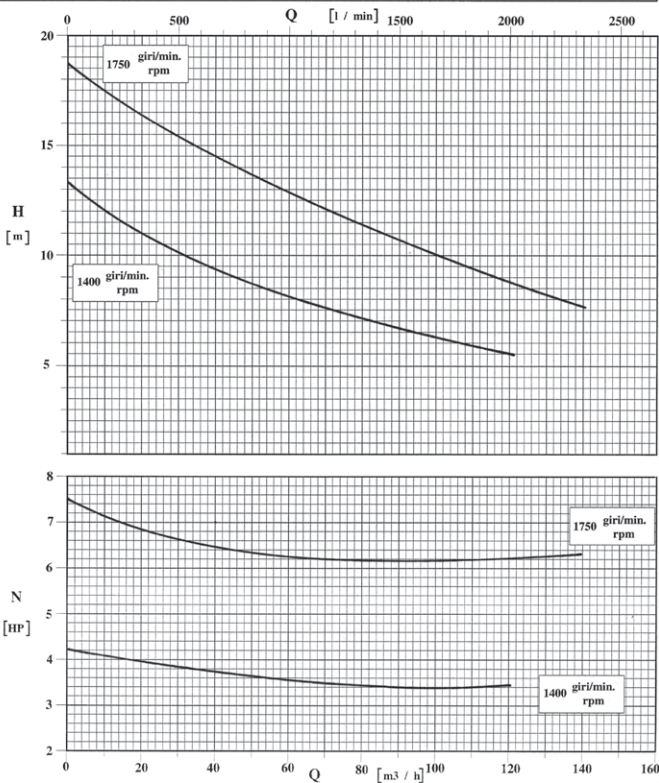

POMPA TIPO <i>Pump type</i>		CR 125			n 1450/1750 giri / min <i>r. p. m.</i>	
GIRANTE — <i>Impeller</i>						
TIPO <i>Type</i>	N° di pale <i>n° of vanes</i>	Pass. sferico <i>max. sphere</i>	Ø max <i>max. diameter</i>	Ø min <i>min. diameter</i>	Bocche tipo <i>Ports type</i>	Bocca aspir. <i>Suction port</i>
APERTA	1 Elica	63 mm	260 mm	---	DIN 11851	DN 125
						Bocca mand. <i>Discharge port</i>
						DN 125
CARATTERISTICHE DI FUNZIONAMENTO CON ACQUA PULITA A 20°C - PESO SPECIFICO 1 (kg/dm³) <i>Curves show performance with clear water at 70°F - Specific gravity 1 (kg/dm³)</i>						

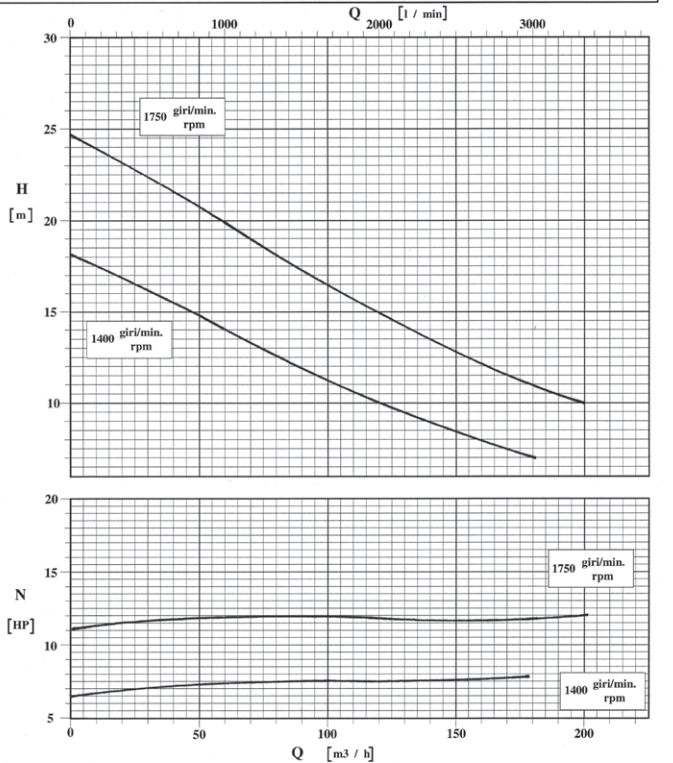

OVERALL DIMENSIONS

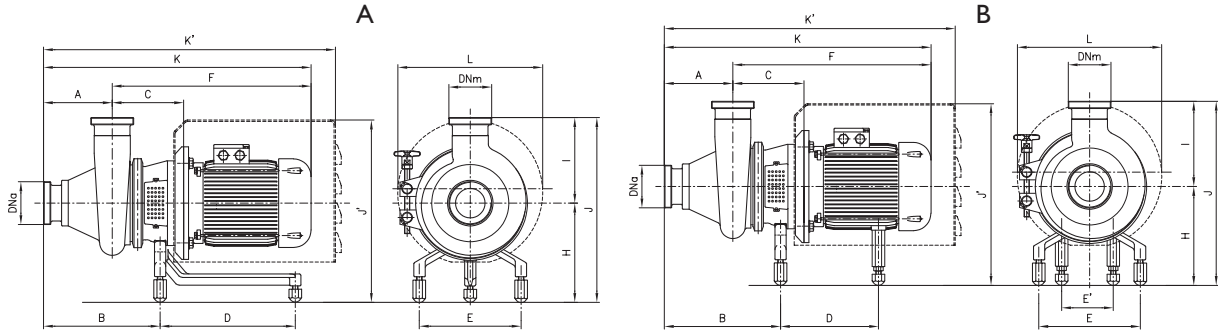

A = motors from 0,55 kW to 4 kW

Dimensions not binding - DN = DIN 11851 male threaded connections, with standard IEC/EN motors

Pumps	rpm	kW	DNa	DNm	A	B	C	D	E	E'	F	H	K	K'	I	J	J'	L																
CR 65		1450	0,55 0,75 1,1 1,5	65	65	151	257	158	230	225	-	392	208	543	657	190	398	374	302															
CR 80	1,1 1,5 2,2 3 4		80																	80	181	297	168	300	225	-	452	213	632	699	245	458	379	302
CR 100	2,2 3 4																																	

B = motors from 5,5 kW to 22 kW

Dimensions not binding - DN = DIN 11851 male threaded connections, with standard IEC/EN motors

Pumps	rpm	kW	DNa	DNm	A	B	C	D	E	E'	F	H	K	K'	I	J	J'	L																
CR 100		1450	5,5 7,5 11 15	100	100	205	325	204	283	225	180	576	238	784	848	294	526	460	370															
CR 125	11 15		125																	125	232	370	230	292	225	180	604	238	836	900	346	584	501	430
	5,5 7,5 11 15 18,5 22																																	

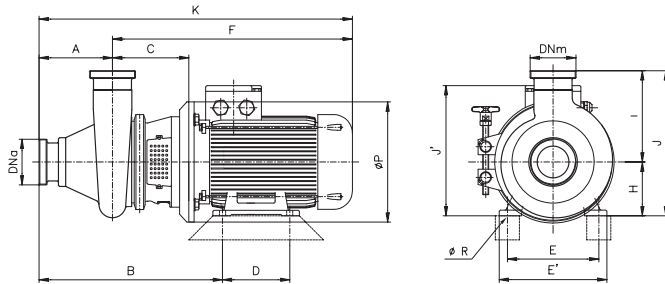

Dimensions not binding - DN = DIN 11851 male threaded connections, with standard IEC/EN motors

Pumps	rpm	kW	DNa	DNm	A	B	C	D	E	E'	F	H	K	I	J	J'	ØP	ØR																
CR 65		1450	0,55 0,75 1,1 1,5	65	65	151	360	158	100	125	150	392	80	543	190	270	200	200	10															
CR 80	1,1 1,5 2,2 3 4		80																	80	181	406	168	125	140	165	452	90	632	245	335	218	200	10
	2,2 3 4																																	
5,5 7,5 11 15	125	125	232	550	230	140	216	256	576	132	781	294	426	299	300	12																		
5,5 7,5 11 15 18,5 22																	270	412	225	230	748	247	980	1035	346	593	510	420						



DEWAELE TECHNICAL AGENCIES
 Hazewindstraat 71
 B-8540 DEERLUK
 T +32 (0)56 73 5671
 bernardcallens@dt-industrial.be
 www.dta-pompen.com



CSF Inox S.p.A. Strada per Bibbiano, 7 - 42027 Montecchio E. (RE) - ITALY EU
 Ph +39.0522.869911 ra. - Fx +39.0522.865454 / 866758 - csfitalia@csf.it - www.csf.it

Export Department • Commercial Étranger • Comercial Extranjero
 Ph +39.0522.869922 - Fx +39.0522.869841 - csfexport@csf.it - www.csf.it

All the instructions, data and representations (in whatever way executed) listed in this publication are indicative and do not binding. CSF does not stand surety or undertake any obligation for the utilisation of this document and for the information contained. In particular, it does not guarantee against omissions or errors of the data and drawings here indicated.
 Notice that the technical specifications, information and representations in this document are merely indicative and approximate. CSF INOX reserves the right at any moment and without notice to modify the data, drawings and information indicated in this document.