



Centrifugal Sanitary Pumps

CS - CSX series

Standard design

Closed coupled hygienic centrifugal pumps with open impellers. CS Series pumps meet the highest requirements of the food, pharmaceutical, chemical and water treatment industries. The pumps are designed to a modular concept, resulting in a large number of models and a massive performance range. When combined with the extremely robust construction, these highly efficient pumps become ideal for any hygienic process system.

Wetted parts in CF-3M 1.4404 / AISI 316L stainless steel, investment cast and electro-chemically polished. Special internal finishes to 0,5 micron Ra are available on request (not on sizes 125 to 150).

Separate IEC standard motor.
Flow rates up to 500 m³/h, heads up to 100 m (10 bar) performance, with low NPSH values.

The clamp casing and seal design allows quick disassembly for inspection, cleaning and maintenance. It also enables the discharge port to be rotated to any position for easy installation (sizes 125 to 150).

For aggressive products and environments, CS pumps can, on special request, be manufactured in the following materials:

- Sanicro 28 (1.4563)
- Duplex SAF 2507 (1.4410)
- Hastalloy C276

Seals:

Mechanical seals with seats to EN 12756, ISO 3069 standards.
Single internal mechanical seal
Single external mechanical seal
Double flushed mechanical seal

Elastomers (certified to FDA):

- EPDM
- Fluorocarbon (Viton)
- Silicone
- P.T.F.E. (Fep)

Special version equipped with an inducer in the suction port. This device is fitted immediately upstream of the impeller to reduce the NPSH required by the pump.



CS pump with shroud and adjustable feet.

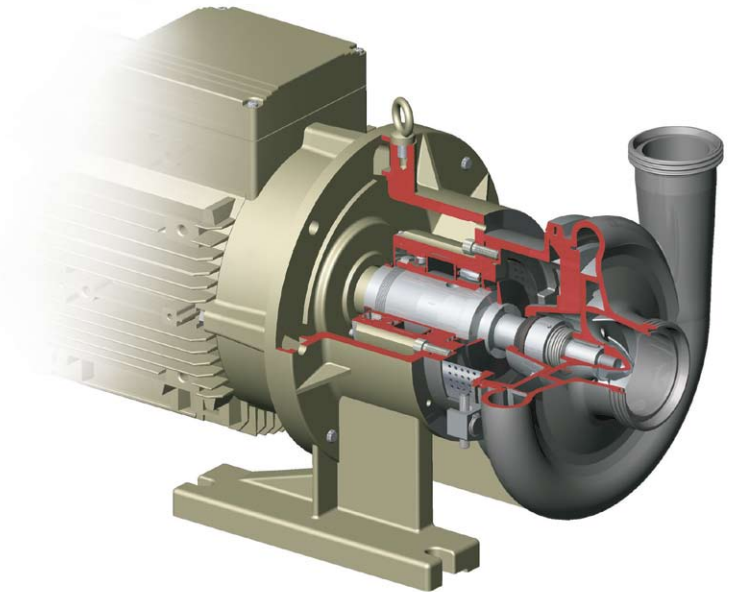

CS pump X execution
Close coupled centrifugal pumps with separate support frame and grease lubricated bearings, for extremely arduous applications.

Connections:

DIN - SMS - IDF - BS / RJT - DS - CLAMP and EN 1092-1 PN 16 flanges suitable for all international standards.

A wide range of 29 models divided into 4 groups.

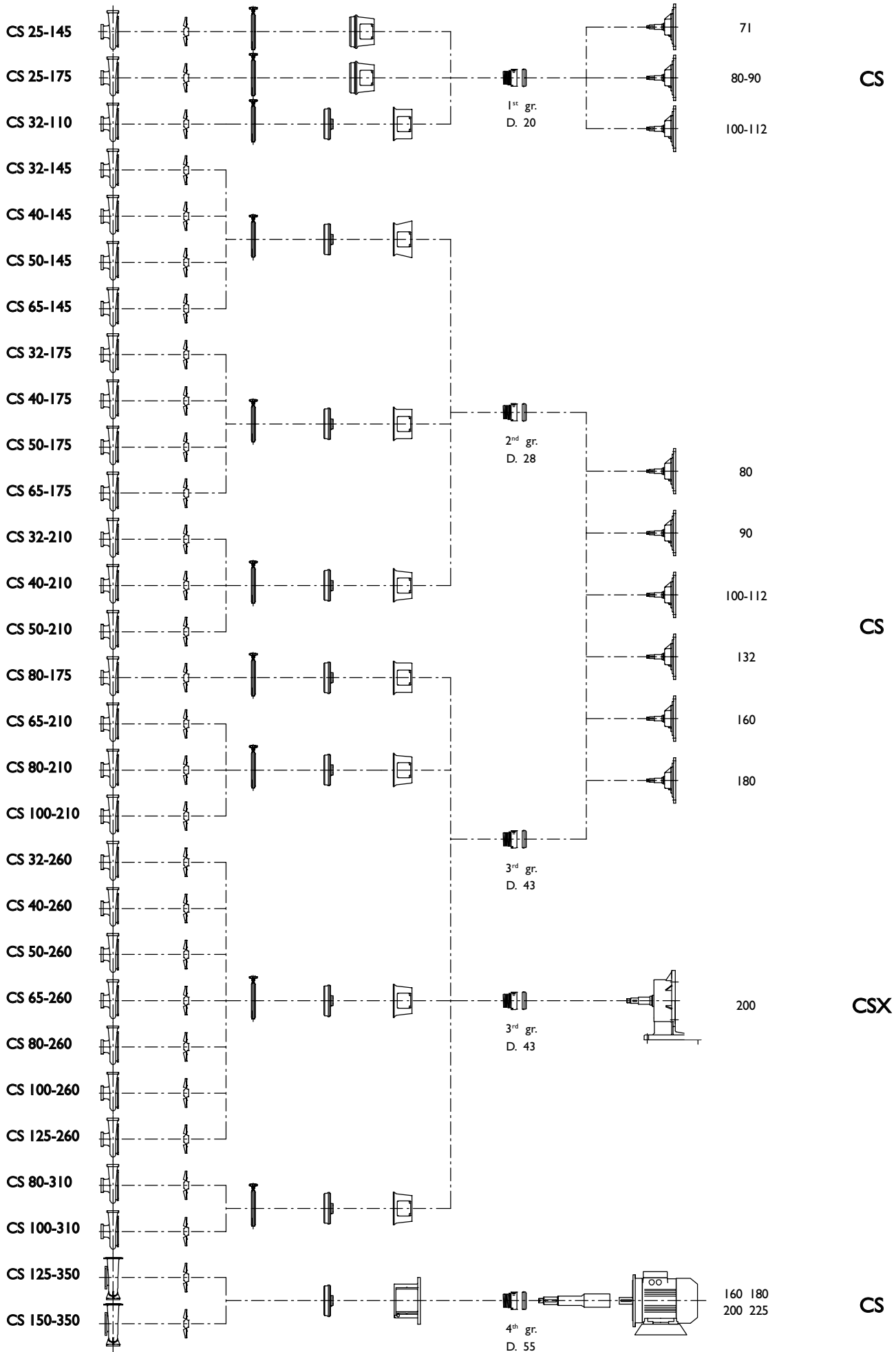

GENERAL DIAGRAMS

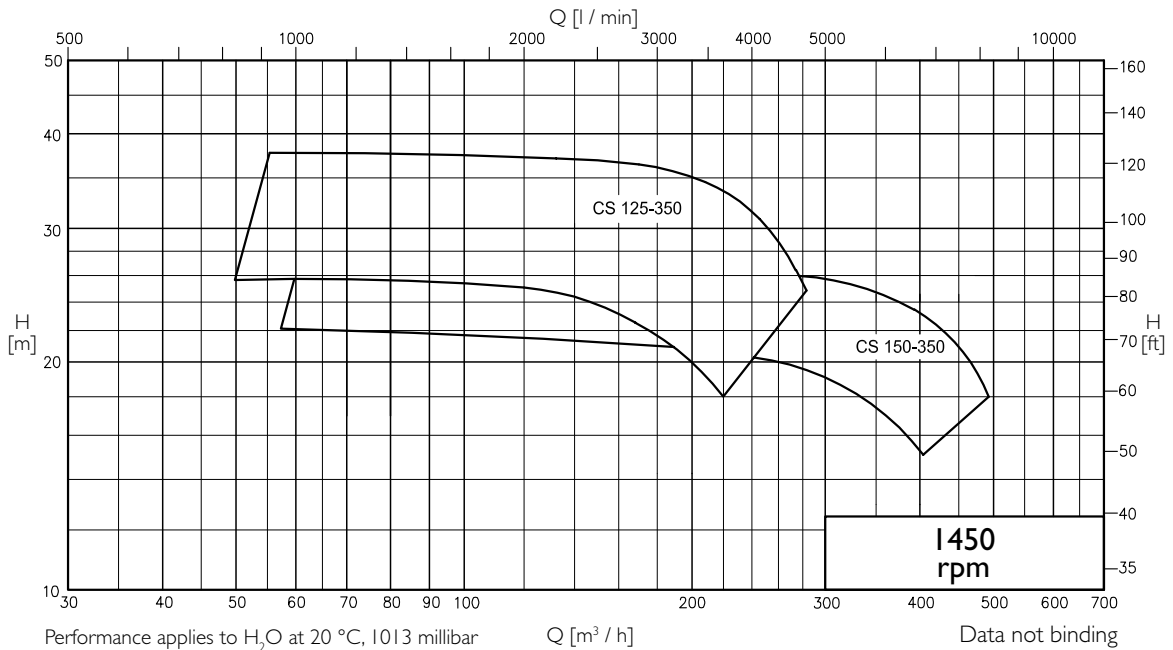
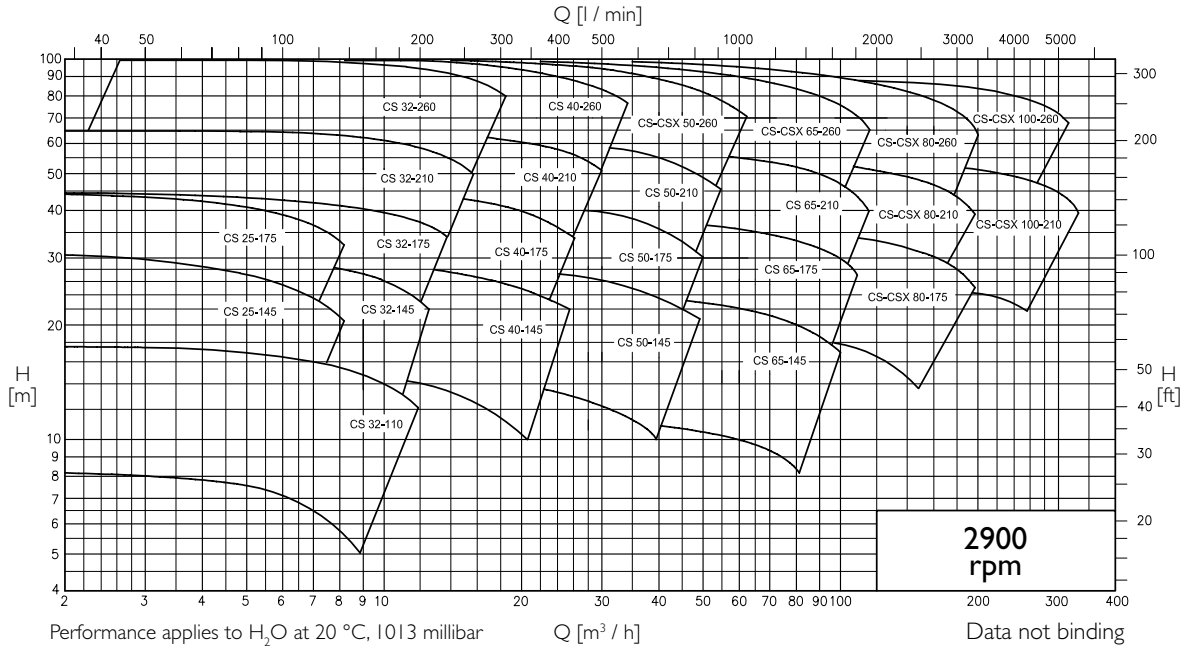
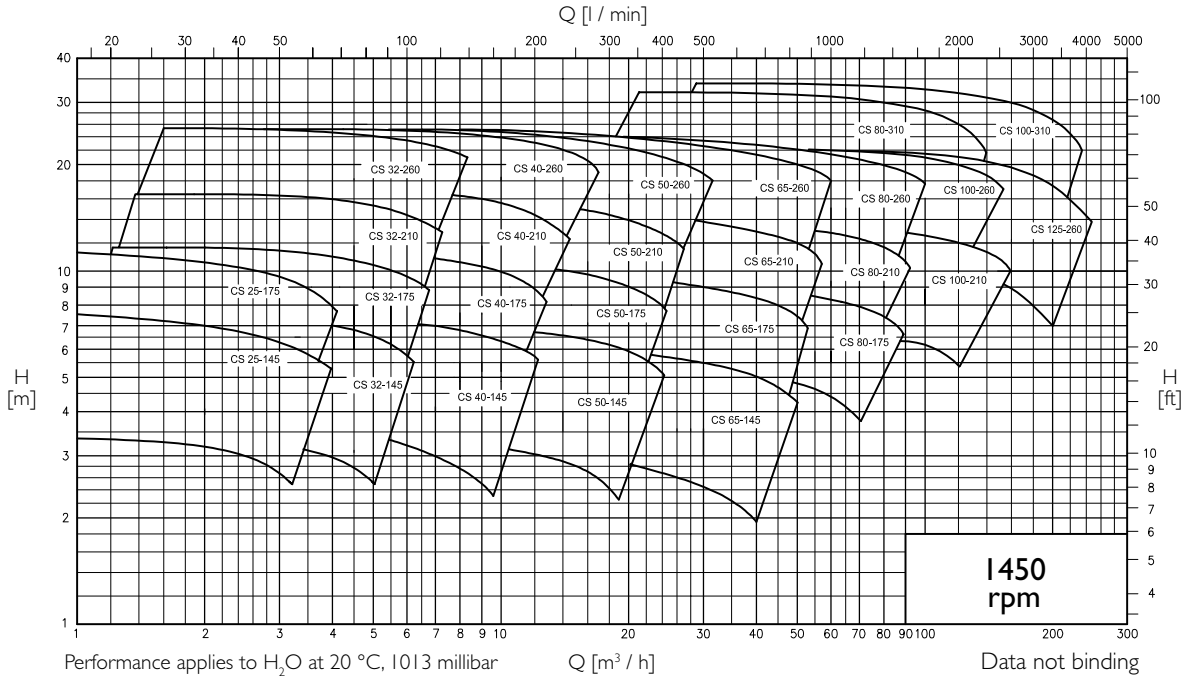

OVERALL DIMENSIONS

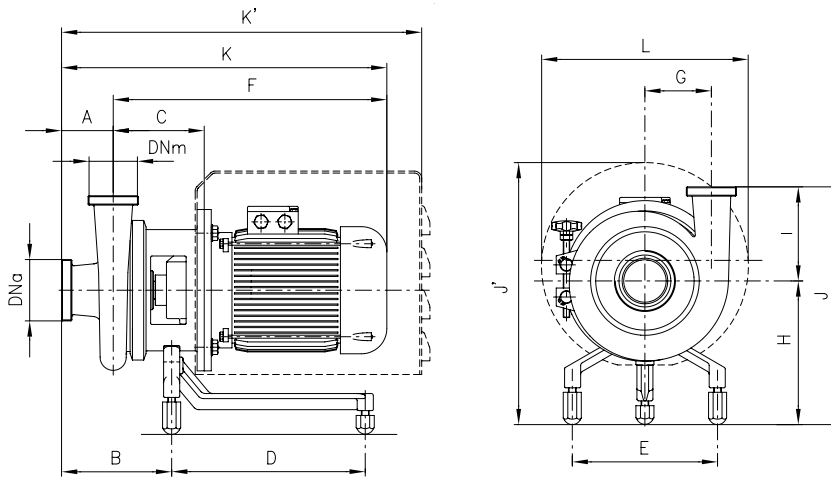

Dimensions not binding - DN = DIN 11851 male threaded connections with standard IEC/EN motors

Pumps	IEC motors size:	DNa	DNm	A	B	C	D	E	F	G	H	K	K'	I	J	J'	L								
CS 25-145	71	32	25	75	144	117	190	178	335	81	158	410	532	145	303	300	239								
	80					123			359			434	541			340	298								
	90					403			478																
CS 25-175	71	32	25	65	134	117	190	178	335	96	164	410	522	149	313	306	239								
	80					123			359			424	531			346	298								
	90					403			468																
	100					138	301	225	454		519	619	359			353	330								
	112					466																			
CS 32-110	71	40	32	70	137	117	190	178	335	65	149	405	527	110	259	291	239								
	80					123			359			429	536			331	298								
	90					403			473																
CS 32-145	80	40	32	80	167	138	231	225	374	85	208	454	566	145	353	372	298								
	90					418			498																
	100					139	301		455		535	370						430	330						
	112					467																			
CS 32-175	80	40	32	80	167	139	231	225	375	95	213	455	567	150	363	385	298								
	90					419			499																
	100					140	301		456		536	380						435	330						
	112					468																			
CS 32-210	80	40	32	80	158	139	231	225	375	110	221	455	567	165	386	385	298								
	90					419			499																
	100					140	301		456		536	403						443	330						
	112					467																			
CS 32-260	90	50	32	90	184	163	231	225	443	140	221	533	601	172	393	385	298								
	100					164			301			480						570	410	443	330				
	112					492																			
CS 40-145	80	50	40	80	168	139	231	225	375	90	208	455	567	133	341	372	298								
	90					418			498																
	100					140	301		455		535	358						430	330						
	112					467																			
CS 40-175	80	50	40	80	169	141	231	225	377	95	213	457	569	150	363	377	298								
	90					421			501																
	100					142	301		458		538	380						435	330						
	112					470																			
CS 40-210	80	50	40	80	161	141	231	225	377	115	221	457	569	165	386	385	298								
	90					421			501																
	100					142	301		458		538	403						443	330						
	112					470																			
CS 40-260	90	50	40	100	194	163	231	225	443	145	221	543	611	172	393	385	298								
	100					164			301			480						580	410	443	330				
	112					492																			
CS 50-145	80	65	50	80	170	141	231	225	377	95	208	457	569	145	353	372	298								
	90					421			501																
	100					142	301		458		538	370						430	330						
	112					470																			
CS 50-175	80	65	50	80	169	141	231	225	377	100	213	457	569	150	363	377	298								
	90					421			501																
	100					142	301		458		538	380						435	330						
	112					470																			
CS 50-210	90	65	50	80	161	141	231	225	421	120	221	501	569	165	386	385	298								
	100					142			301			458						538	402	443	330				
	112					470																			
CS 50-260	100	65	50	90	185	165	301	225	481	145	238	571	671	175	413	443	330								
	112								493																
									381			460													
CS 65-145	80	80	65	79	173	145	231	225	381	112	208	460	572	145	353	372	298								
	90								425			504													
	100								146			301						225	462	541	642	145	370	430	330
	112								474																
CS 65-175	90	80	65	80	172	144	231	225	424	120	213	504	572	150	363	377	298								
	100					145			301			461						541	641	380	435	330			
	112					473																			
						448																			
CS 65-210	90	80	65	90	189	168	231	225	448	135	221	538	605	165	386	385	298								
	100					169			301			485						575	403	443	330				
	112					497																			
CS 65-260	100	80	65	100	198	168	301	225	484	155	238	584	684	205	443	443	330								
	112								496																

